



## Miri Air User Manual

- ✓ Product Specifications
- ✓ What's in the Box
- ✓ What You'll Need
- ✓ Setting up your Climate in Africa Account
- ✓ Setting up your Miri Air Device
- ✓ Installation Guidelines
- ✓ Troubleshooting
- ✓ Maintenance
- ✓ For Support

## Miri Air Quality Device

### ..... Precision Air Monitoring at Your Fingertips

Thank you for choosing the **Miri Air Quality Device** — a cutting-edge air monitoring system developed by Climate in Africa. Designed in compliance with WMO standards. It tracks key environmental parameters including: -

- ✓ Temperature
- ✓ Humidity
- ✓ Pressure
- ✓ CO, NO<sub>2</sub>, CO<sub>2</sub>
- ✓ PM2.5, PM10
- ✓ CH<sub>2</sub>O, CH<sub>4</sub>, SO<sub>2</sub>
- ✓ Ambient Noise

Empowering communities, researchers and decision-makers to act smarter, faster, and more sustainably.



device-3355a6

ID: rRAG9d57gX

96% 93% X

Chart

Notifications

Settings

device-3355a6, null

Last 1 Week

Select Variables

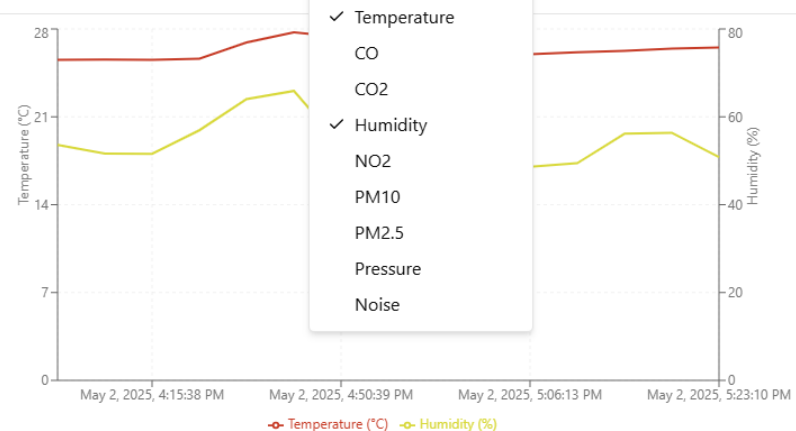

## Product Specifications

Feature	Specification
Height	23.5cm
Diameter	29cm
Weight	2 Kg (70.55 oz)
Base Material	Acrylonitrile Butadiene Styrene (ABS)
Processor	Ultra-low-power 32-bit MCU Arm Cortex STM32 MCU
Communication Method	GPRS
Power Supply	Solar-Powered
Battery Capacity	8,000mAh
Back-Up Time	3 days
Operating Temperature	-30°C to 85°C
Storage Temperature	-30°C to 85°C
Operating Humidity	0% to 100%
Status Indicator	RGB LED
OTA Updates	Supported

### What's in the Box

- ✓ Miri Air Quality Device x1
- ✓ User Guide x1

### What You'll Need

- ✓ A smartphone or tablet or laptop
- ✓ A Climate in Africa account
- ✓ An internet connection

## Setting up your Climate in Africa Account

1) Visit [app.climateinafrica.com/sign-up](https://app.climateinafrica.com/sign-up), Enter your details and Click Sign-Up



**Sign up to the  
Climate in Africa Network**

**Full Name**

**Account Type**

Individual or Organization? ▼

**Email**

**Password**

**Confirm Password**

**Sign Up**

Already have an account? [Sign In](#)

OR

 Continue with Google

2) Check your email and activate your account.

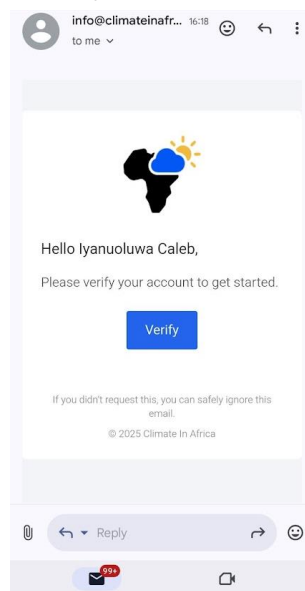

3) You will be redirected to the log in page upon successful registration. Enter your details and sign in

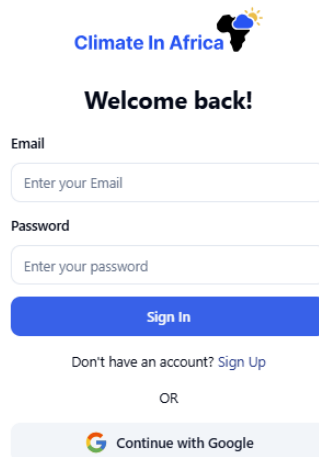

The login page features the 'Climate In Africa' logo at the top. Below it is a 'Welcome back!' message. There are two input fields: 'Email' with the placeholder 'Enter your Email' and 'Password' with the placeholder 'Enter your password'. A blue 'Sign In' button is positioned below the password field. Below the button is a link that says 'Don't have an account? Sign Up'. Further down, separated by an 'OR' text, is a 'Continue with Google' button featuring the Google logo.

4) Once logged in, click **Add Device** when prompted.



This is a mobile app onboarding screen. At the top is the 'Climate In Africa' logo. Below it is a large image of a white weather station device. The text reads: 'Welcome to the Climate in Africa Network! Firstly, let's add your device to the network. You would need your device ID for this. It can be found at the bottom of your device.' Below this text is a blue 'Add New Device' button. At the bottom of the screen is a red 'Logout' button.

5) Enter the **Device ID** (found on the device body). You will be redirected to your device dashboard upon successful registration.



This is a dialog box titled 'Add New Device'. It contains the text: 'Input your weather station device ID below. Your device ID can be found at the bottom of your device.' Below this is a label 'Device ID' and a text input field with the placeholder 'Enter your Device ID'. At the bottom right of the dialog are two buttons: a grey 'Close' button and a blue 'Add Device' button.

### Setting Up Your Miri Air Device

- ✓ Install your device at the intended monitoring location.
- ✓ Locate the one-time **toggle switch** underneath the unit.
- ✓ Turn it on to activate the device.

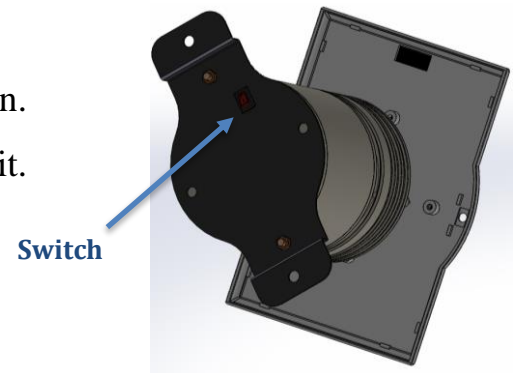

### Installation Guidelines

- ✓ Mount the device **1.5 meters above ground level** on a sturdy platform.
- ✓ Avoid placement near surfaces that can reflect **radiant heat**.
- ✓ Ensure protection from **splashing water** or direct rainfall entry.

### Troubleshooting

If the device is not recording data correctly:

- ✓ Check for firmware updates via your dashboard.
- ✓ Contact technical support for **sensor calibration** assistance.

### Maintenance

- ✓ **Clean the solar panel** monthly during summer for optimal performance.
- ✓ For diagnostics or issues, please reach out to our support team.

### For Support

 Email: [info@climateinafrica.com](mailto:info@climateinafrica.com)

 Phone: +234 806 948 9295

**Thank you for choosing Miri Air**